

I-35W BRT Operations

MVTA Board
April 23, 2008



Context

- 2003: I-35/35W BRT Study (MnDOT)
- 2007: UPA Projects

2003 I-35/35W BRT Study

Phased Implementation Plan

- Phase I
 - HOV lane north to 42nd Street
 - Online Station at 46th Street
 - Lakeville North Park & Ride (440 spaces)
 - Bus-only Shoulders Lakeville-Burnsville
 - Hourly Station-to-Station service between Lakeville & Minneapolis
 - Lakeville-Minneapolis express service (7 trips in each direction)



2003 I-35/35W BRT Study

Phase I

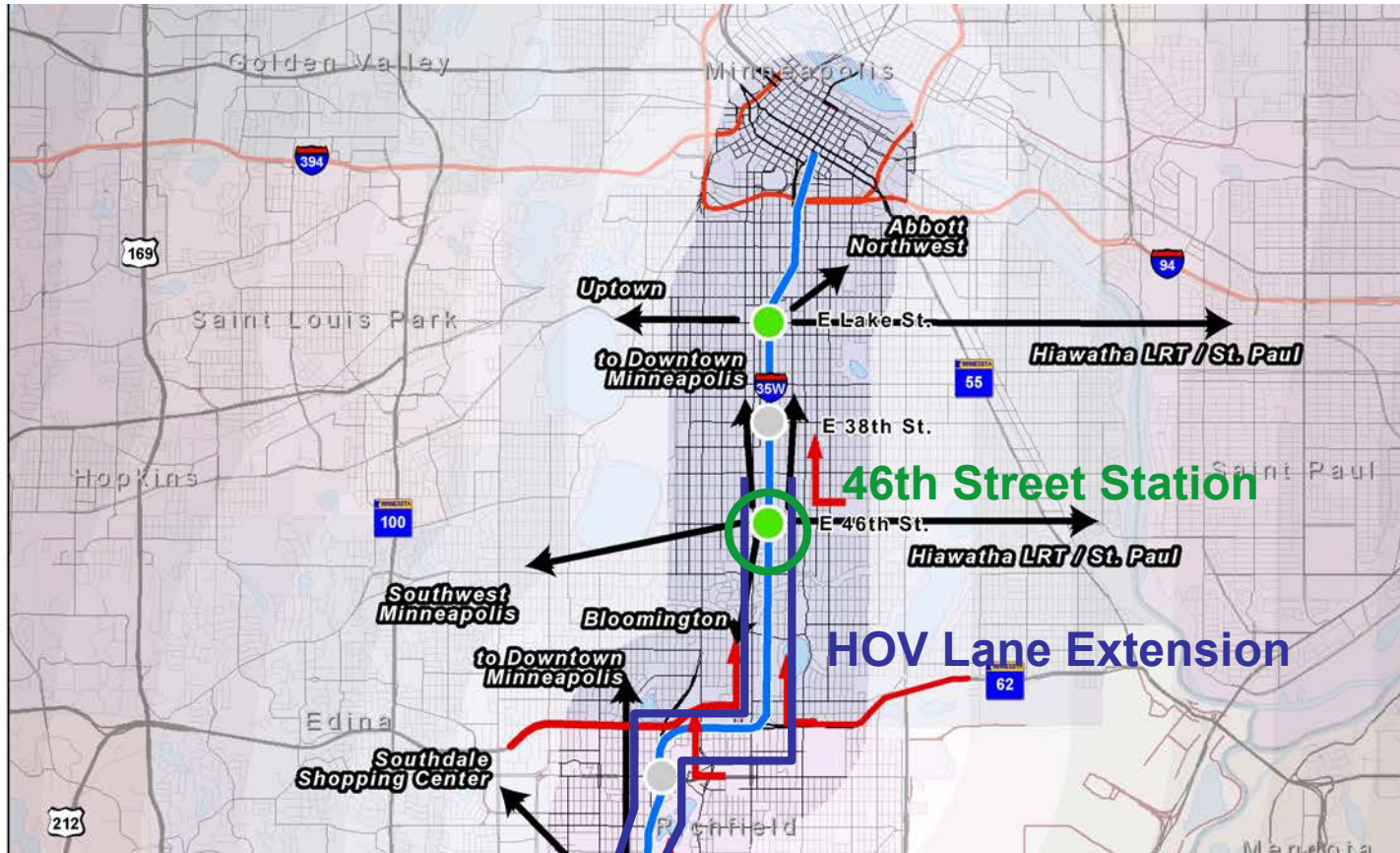

2003 I-35/35W BRT Study

Phase I

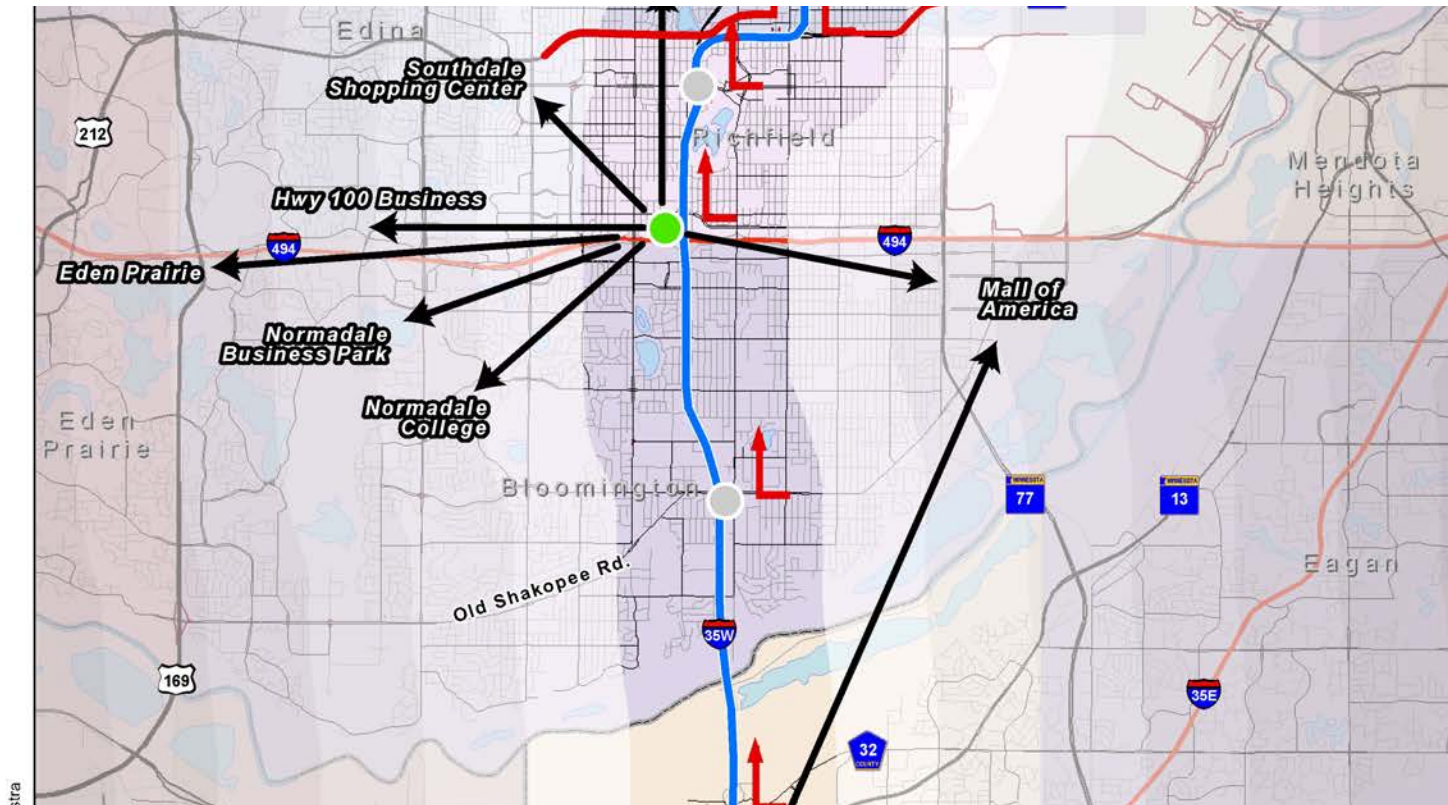

2003 I-35/35W BRT Study

Phase I

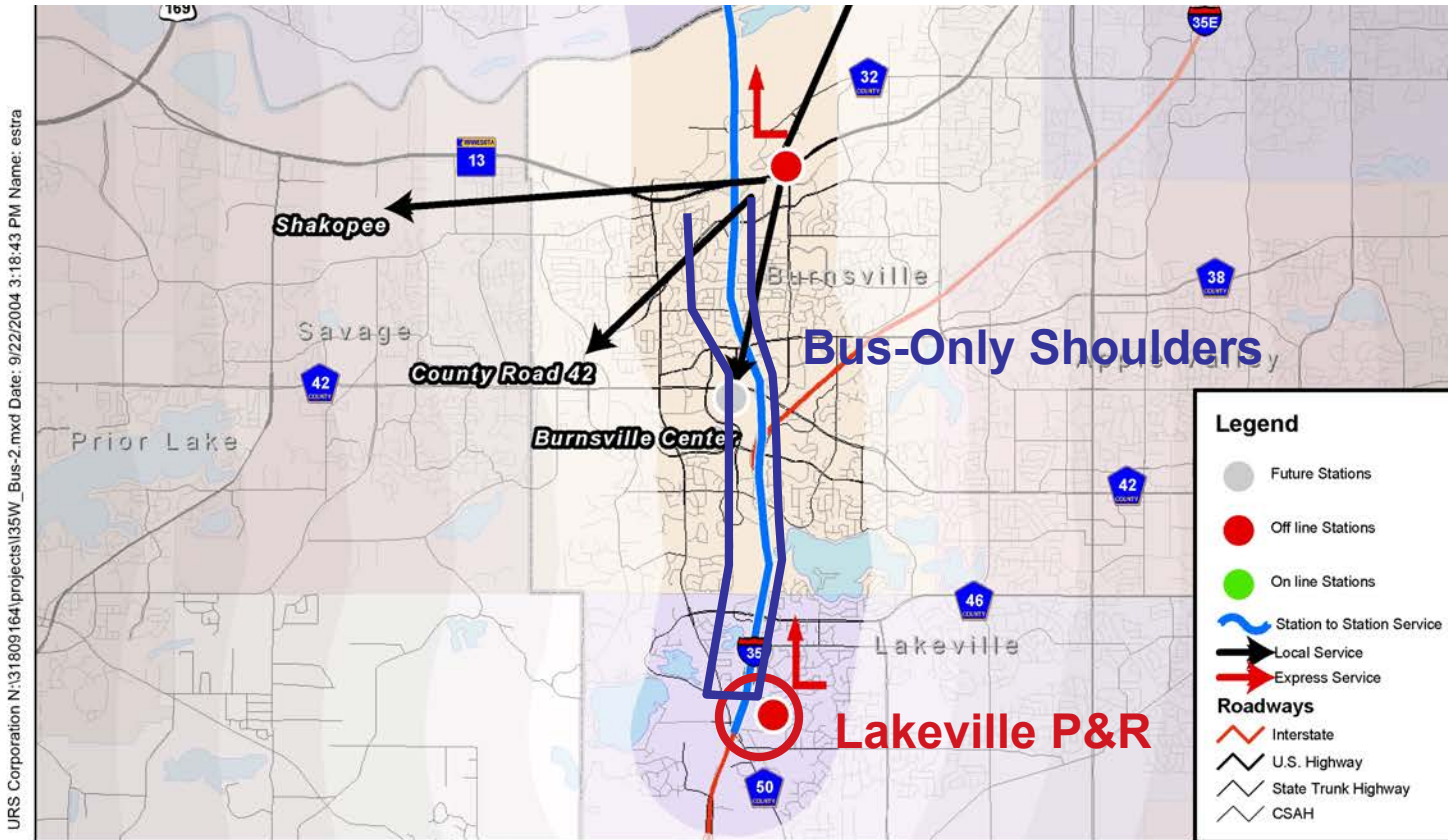

Data Sources: MnDOT, URS, MetroTransit, MetCouncil, DNR

September 2004

2003 I-35/35W BRT Study

Phase I: 46th Street Station

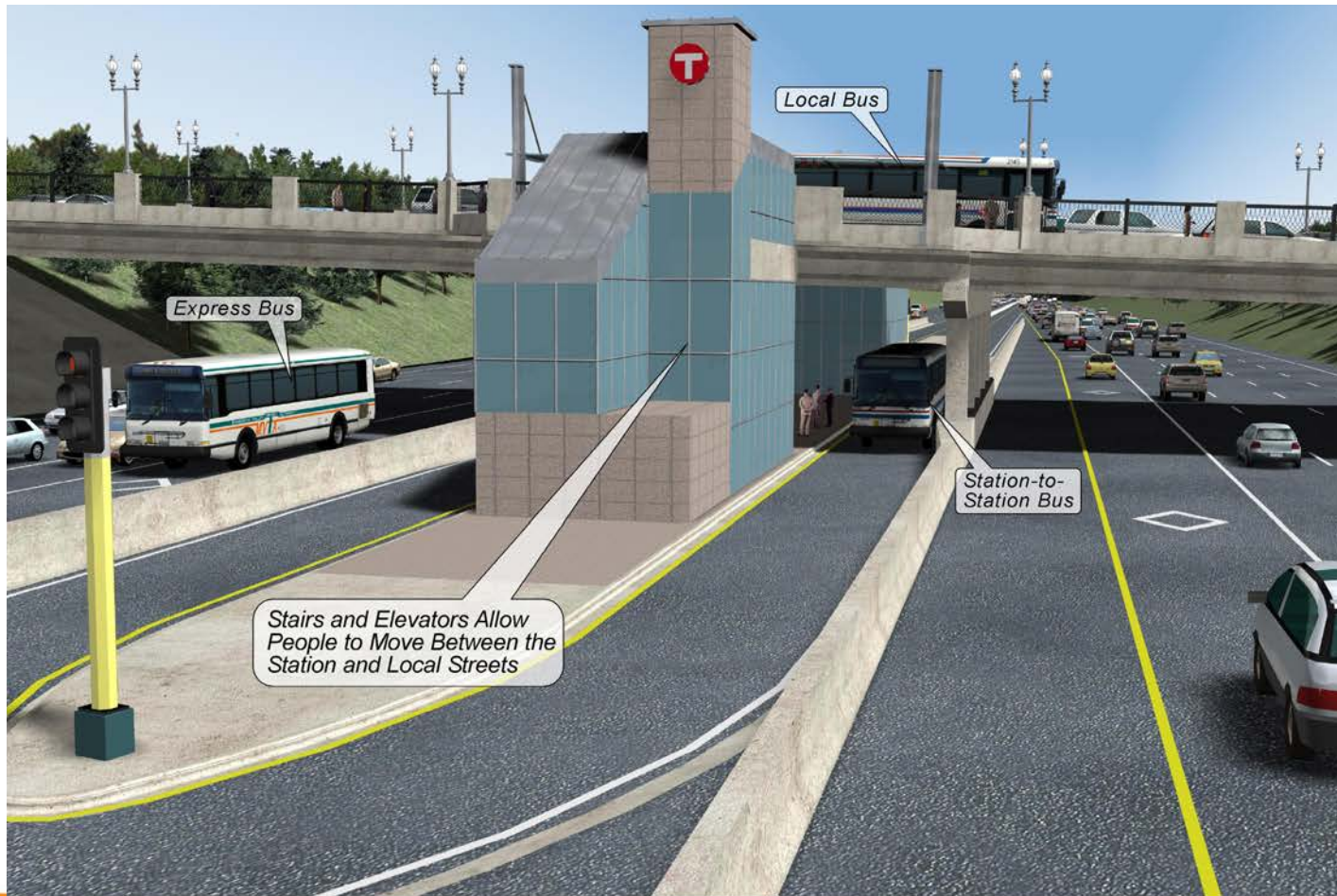

2003 I-35/35W BRT Study

Phase I: Lakeville Park & Ride



2003 I-35/35W BRT Study

Phased Implementation Plan

- Phase II
 - HOV lane north to downtown
 - Online Station at Lake Street
 - Online Station at I-494 (American Blvd./82nd St.) and nearby park & ride
 - Expanded bus operations



2003 I-35/35W BRT Study

Phase II

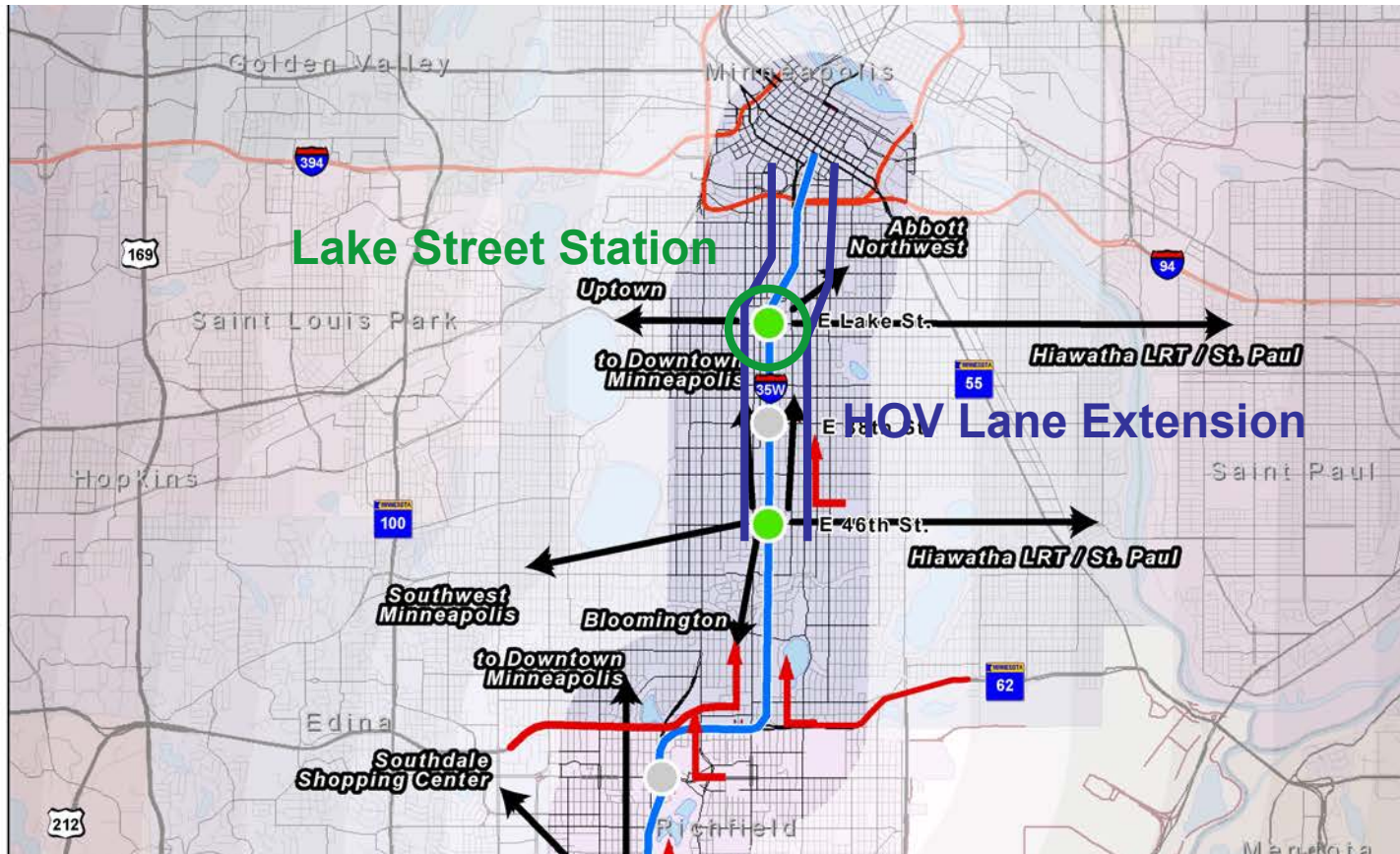

2003 I-35/35W BRT Study Phase II

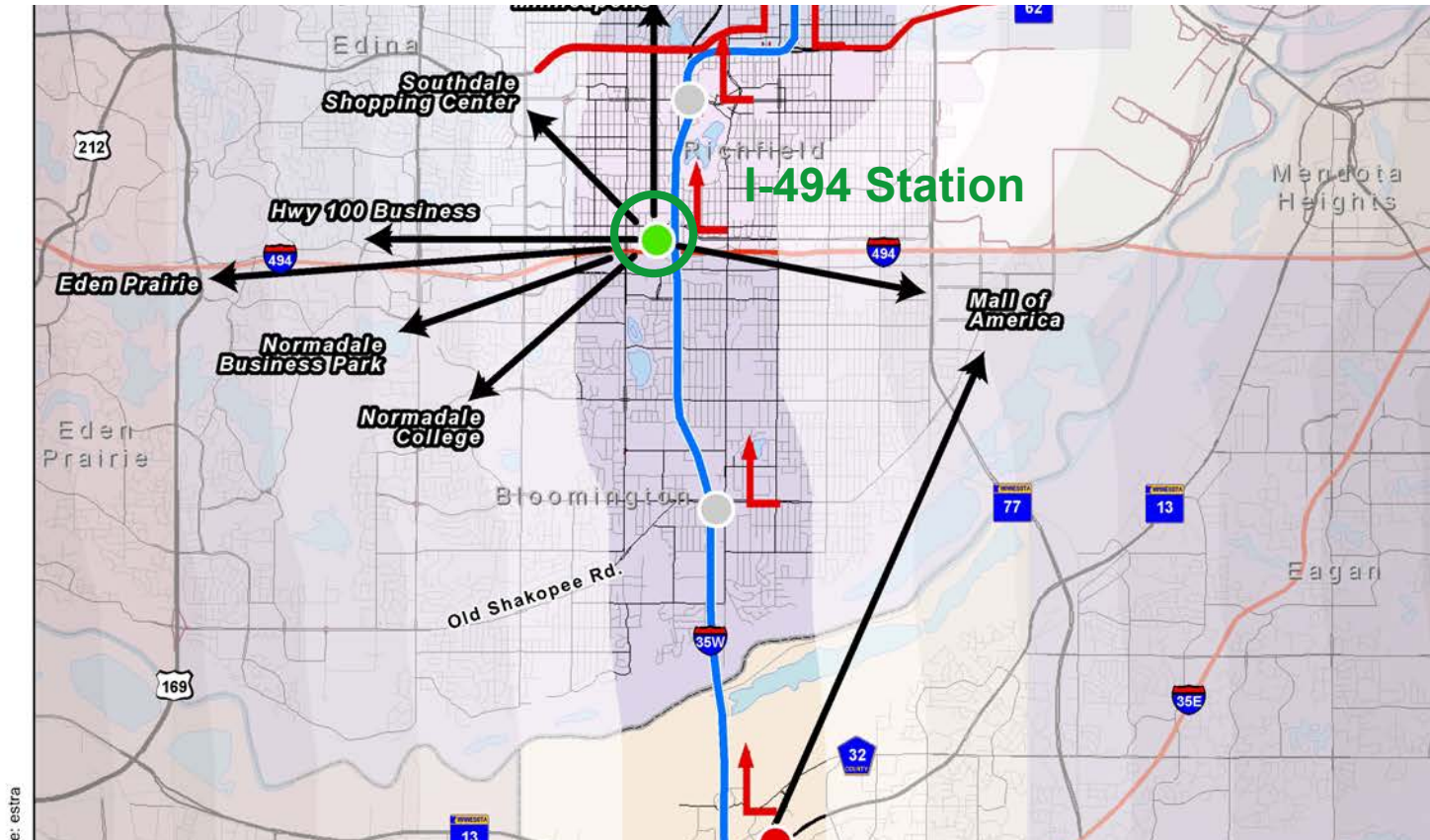

2003 I-35/35W BRT Study

Phased Implementation Plan

- Long-Term
 - BRT/HOV lane south to Lakeville
 - Parking Structure at Lakeville
 - Add park & ride at CR 70 in Lakeville
 - Potential center transit stations at 98th, 66th, 38th



I-35W UPA Program

1 Transit Lanes on Marquette and Second Ave
 Lead Agency: Minneapolis
 Description: Adds second bus lane and improved transit stops on each street
 Opens: December 2009

2 Priced Dynamic Shoulder Lanes on northbound I-35W
 Lead Agency: Mn/DOT
 Description: Convert northbound I-35W shoulder to a High Occupancy Toll lane during periods of congestion. From 42nd Street to Hwy 65 Downtown East
 Opens: September 2009

3 High Occupancy Toll Lane
 Lead Agency: Mn/DOT
 Description: Construct northbound and southbound MnPASS HOV lanes between 66th Street and 42nd Street. This is under construction with I-35W/Hwy 62 Crosstown project.
 Opens: October 2010

4 High Occupancy Toll Lane Conversion
 Lead Agency: Mn/DOT
 Description: Convert existing HOV lane on northbound and southbound I-35W into MnPASS HOV lane
 Opens: September 2009

5 Collector Distributor Ramp
 Lead Agency: Mn/DOT
 Description: Construct auxiliary lane and collector distributor ramp on northbound I-35W between 97th St and 69th
 Opens: September 2009

6 Add Auxiliary Lane
 Lead Agency: Mn/DOT
 Description: Construct new lane on southbound I-35W from 106th St. Entrance to westbound 7th Exit
 Opens: September 2009

7 Bus Bypass Ramp
 Lead Agency: Mn/DOT
 Description: Construct Transit Advantage for buses traveling from southbound Hwy 77 to westbound Hwy 62
 Opens: Fall 2008

8 I-35W South Park and Ride
 Lead Agency: Metro Transit
 Description: Construct a new park and ride facility with express bus service in Farmington near I-35W
 Opens: September 2009

HOT Lane

HOV to HOT Conversion

I-494 P&R

I-35W UPA Program

1 Traffic Management and Bus Priority Systems
 Lead Agency: Mn/DOT
 Description: Add cameras, dynamic signs, communications, signal interconnect and signal priority for transit on TH 12 from Nicollet Ave to Hwy 169.
 Opens: September 2009

10 I-35W Lakeville Park and Ride
 Lead Agency: TBD
 Description: Convert former truck weigh station to surface park and ride with express bus service.
 Opens: September 2009

11 Transit station and surface park and ride
 Lead Agencies: MVA and Eagan
 Description: Construct new Cedar Grove Transit Station, park and ride, and add express bus service.
 Opens: September 2009

12 Park and Ride Improvements
 Lead Agency: MVA and Apple Valley
 Description: Install technology, add service and make access improvements to Polovina Hill Station.
 Opens: September 2009

HOV to HOT Conversion

13 BRT Transit Station
 Lead Agencies: MVA and Apple Valley
 Description: Construct BRT Transit Station on Cedar Avenue near 142th Street.
 Opens: September 2009

14 BRT Transit Stop
 Lead Agency: MVA and Apple Valley
 Description: Construct BRT Transit Stop on Cedar Avenue near 147th Street.
 Opens: September 2009

15 BRT Park and Ride
 Lead Agency: Dakota County and Lakeville
 Description: Construct surface park and ride near 180th St and Cedar Avenue.
 Opens: September 2009

16 I-35 North Park and Ride
 Lead Agency: Metro Transit
 Description: Construct surface park and ride, and add express bus service near I-35W and I-554.
 Opens: September 2009

17 Technology
 Lead Agencies: Mn/DOT, Metro Transit, OPICAL LINE B, MVA, U of M

HOV to HOT Conversion

Lakeville P&R

Key Challenges (4)

- Facilities
 - Opening the UPA facilities by fall '09
 - Plan for remaining stations locations

Concept for Burnsville South (Burnsville Center)

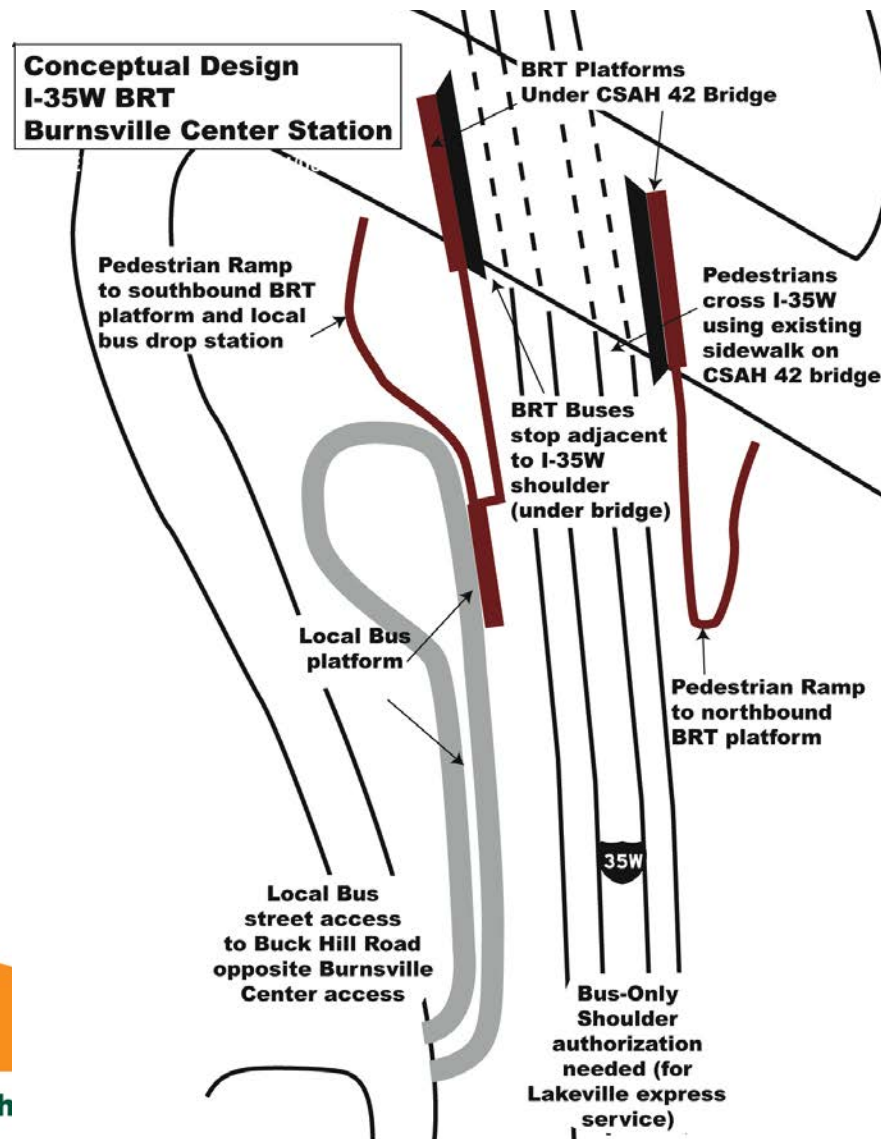

Key Challenges (4)

- Facilities
 - Opening the UPA facilities by fall '09
 - Plan for remaining stations locations
- Operating plan
 - What will operate
 - Who will operate what pieces

Operating Plan?

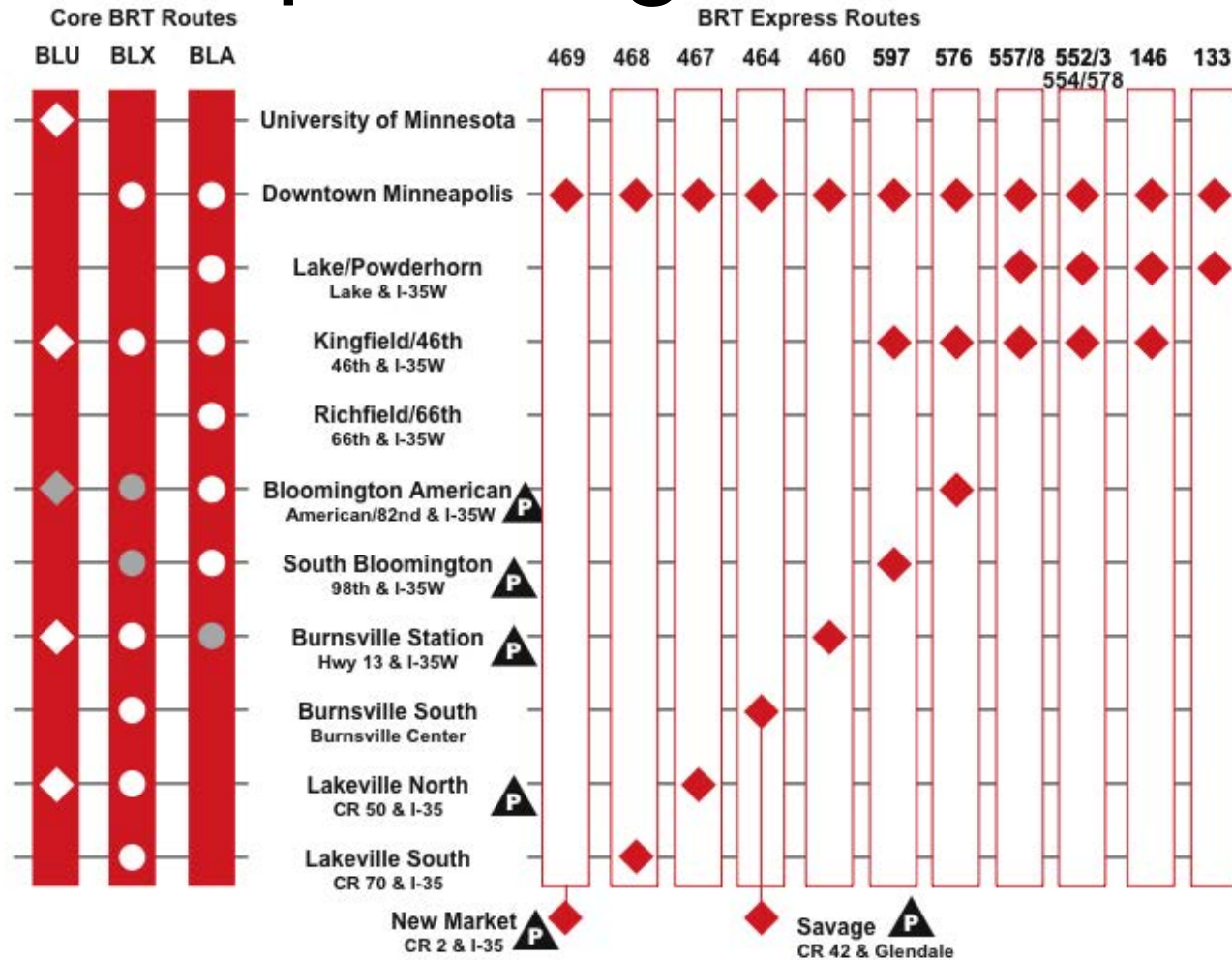

Key Challenges (4)

- Facilities
 - Getting the UPA facilities open by fall '09
 - Plan for remaining stations locations
- Operating plan
 - What will operate
 - Who will operate what pieces
- Funding
 - MVTA & MT need additional operating funds
 - Capital budget to support facilities & buses

Key Challenges

- Underlying all of these is the single greatest challenge:
- What organization is “driving the bus?”
 - MVTA
 - Metro Transit
 - Metropolitan Council
 - Counties (MTDB/JPA)

